



## HSC Ceramics™ Products Installation Manual

We strongly recommend the ceramic bearing and related products installed by a qualified mechanic, and all the installations have to be done with the proper tools.

### Preparation

Remove old bottom bracket, bearing or jockey wheels with proper tools without damaging the frame, hub and derailleur cage.

Clean and remove all dirt, old grease if you are installing the products in a used bike.

Apply a thin layer of grease on the inside of the bottom bracket or hub shell and the outside of the bearing or bottom bracket cups.

### Installation

#### Thread bottom bracket

Use a correct bottom bracket spanner for the English or Italian thread bottom bracket installation with torque at 40NM.

#### Pressfit bottom bracket with cups

Use a proper bottom bracket press tool for the installation. Please make sure a correct size drift has been selected.

#### Bottom bracket for SRAM GXP cranks

This type of bottom bracket comes with a 2mm width black plastic spacer and a silver metal wave washer.

Both the black plastic spacer and the silver metal wave washer are not required if there is no play after installing the SRAM GXP cranks.

However, if you have already used a similar spacer or wave washer with your current bottom bracket, and then you will apply the same to our bottom bracket to eliminate the play.

Depend on the space/play, please pick either the black plastic spacer or wave washer, or both and install them on the **Drive Side**.

## Instructions for specific bottom brackets

### **Pressfit30/EVO386/BBright**

A 30mm ID wave washer is provided and can be used on the **Drive Side** to eliminate any plays. Please install the bottom bracket and crank without the wave washer first. If any play appears in between the crank arm and the bottom bracket, please redo the installation with the wave washer on the **Drive Side**.

Additional 30mm ID x 2mm width plastic spacer(s) are provided with MTB version bottom brackets. Use the spacers upon the width combinations of your frame shell and the cranks.

### **BB30**

Apply a thin layer of grease on the inside of the bottom bracket shell and the outside of the bearing, and then follow the diagram to assemble the BB30 bottom bracket bearings with the components. The Wave Spacer applies to the **Non-drive Side**.

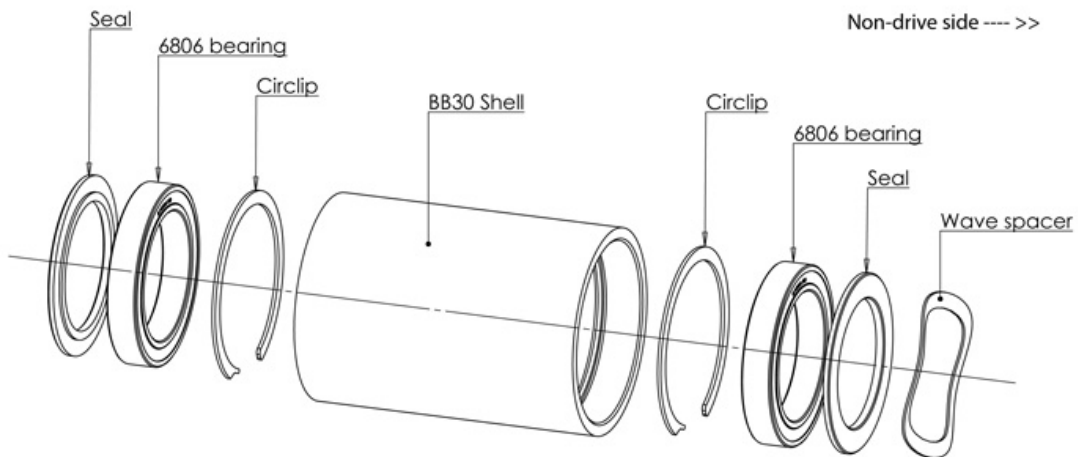

### **PressFit30 OSBB Shimano/SRAM**

Included with this bottom bracket are 2 x 3mm plastic spacers/rings with 46mm ID. Those are used only for Specialized OSBB carbon shells with 62mm width.

Place one 3mm plastic spacer/ring on each side of the bottom bracket cup before pressing into the bottom bracket shell.

### **BB92/41**

Bottom bracket comes with 2mm plastic spacer(s). Place 1 spacer on a 89mm width bottom bracket shell **Drive Side**; No spacer(s) is required for a 92mm width bottom bracket shell.

### **Campagnolo Ultra Torque**

We only provide ceramic bearings for Campagnolo Ultra Torque system. Please replace the bearings **ONLY**, but use the rest components from the current bottom bracket.

## **BB42**

Please follow the diagram to install the bottom bracket for road frames.

Additional 24mm ID x 2mm width plastic spacer(s) are provided for MTB version. Use the spacers upon the width combinations of your frame shell and the cranks.

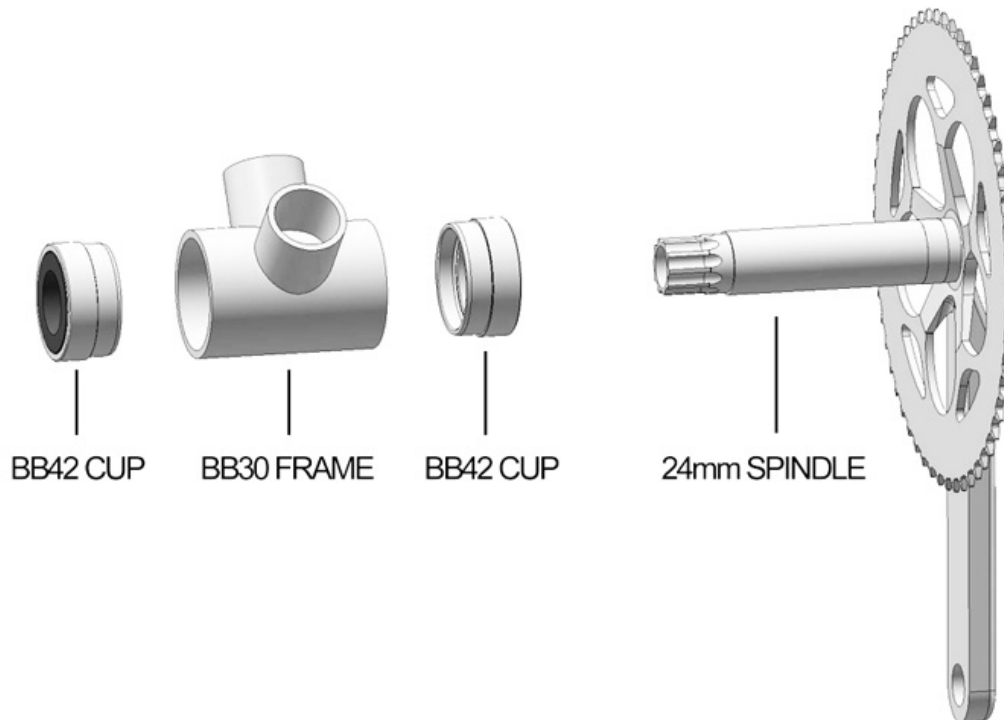

## **Rear derailleur pulleys**

HSC ceramic pulleys are CNC machined, hence there are no difference in between upper and lower wheels.

All our pulleys are 11-speed compatible with Shimano, SRAM and Campagnolo.

All our pulleys also work with 10-speed Shimano and SRAM rear derailleurs with spacers. There are 4 metal spacers in the package and use 1 spacer on each side of pulley wheel (on top of the dust cover) to build up the width for the 10-speed system.

We also provide a separate 4mm ID metal sleeve for the SRAM 4mm bolt. So please select the option if you need it.

**Important note:** we use the grease for the bearing lubrication hence the wheels won't free spin in hand, but it doesn't affect the actual performance.

Please feel free to contact [teamhsc@hscceramics.com.au](mailto:teamhsc@hscceramics.com.au) if you have any questions in terms of the products or installations.